

MUCK-TRUCK

MAX Mk III Dumper

POWERED BY



Owner, Operation, & Parts Manual

Models

Muck-Truck Mk V Dumper
MAX Mk III Dumper
Starting with Serial Number 10001

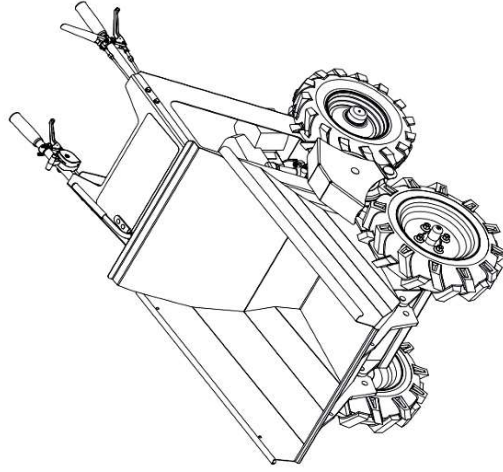

 ENGLISH



INTRODUCTION

THE MANUAL

Before using the unit, carefully and completely read your manual. The contents will give you an understanding of safety instructions and controls during normal operation and maintenance.

All reference to left, right, front, or rear is given from the operator's position, facing the direction of forward travel.

ENGINE MANUAL

A separate manual specific to the engine covers the engine on this unit. This manual is included in the literature package that shipped with the unit. Refer to this manual for engine service recommendations. If the engine manual is not available, contact the engine manufacturer for a replacement manual.

PURCHASE INFORMATION

Please record the following information about your unit and have it available before contacting us.

Serial Number:

Dealer/Distributor's Name:

Date of Purchase:

Year of Manufacture:

ASSEMBLY

Install Handles

Handles are shipped in downward position (see Figure 1) with all levers and cables correctly positioned.

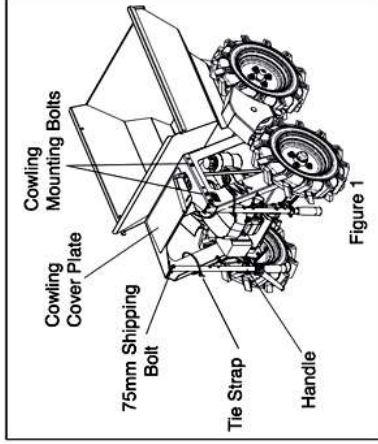

Figure 1

4. Insert M8 x 50 hex bolt from Manual Package into remaining hole and secure with washers and nut removed from shipping bolt.

5. Tighten hardware securely.

6. Repeat steps 2 – 5 for remaining side.

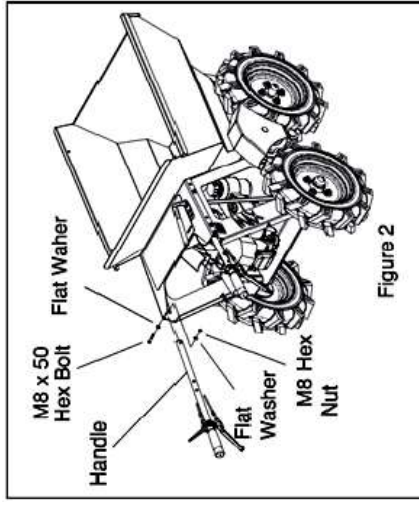

Figure 2

1. Cut tie-straps retaining handles.
2. Remove M8 x 75 shipping hex bolt securing handle to unit. Retain nut and washers; discard 75mm hex bolt.
3. Align handle with the holes in the cowling cover and attach with two M8 x 50 bolts, washers and M8 Nyloc nuts removed earlier.

DECLARATION OF CONFORMITY

The undersigned of Muck-truck UK Ltd, declare that the Pedestrian Dumper Trucks:

Category: EGO Battery Engine

Model: Muck-truck Mk V Dumper/ MAX Mk III Dumper

Declare that the product Universal Power Unit PU2700B complies with the essential health and safety requirements of the following Regulations/Directives:

S.I. 2008:1597, S.I. 2016:1091, S.I. 2012:3032

Standards and technical specifications referred to:

EN IEC 55014-1:2021, EN IEC 55014-2:2021, EN 62841-1:2015

PU2700B S/N: EPU04222000001X - EPU04372099999X

In response to a reasoned request by the national authorities, relevant information on Universal Power Unit PU2700B has been transmitted.

Universal Power Unit PU2700B must not be put into service until the final machinery into which it is to be incorporated has been declared in conformity with the provisions of this directive.

NAME & SIGNATURE OF TECHNICAL MANAGER OF MUCK-TRUCK UK LTD.

TERRY ROWLANDS

SAFETY

SAFETY ALERT SYMBOL

These are safety alert symbols. They mean:

- **ATTENTION!**
 - **YOUR SAFETY IS INVOLVED!**
- When you see this symbol:
- **BECOME ALERT!**
 - **OBEY THE MESSAGE!**



SIGNAL WORDS

The safety alert symbols above and signal words below are used in this manual. Read and understand all safety messages.

DANGER: IMMINENTLY HAZARDOUS SITUATION! If not avoided, WILL RESULT in death or serious injury.

WARNING: POTENTIALLY HAZARDOUS SITUATION! If not avoided, COULD RESULT in death or serious injury.

CAUTION: POTENTIALLY HAZARDOUS SITUATION! If not avoided, MAY RESULT in minor or moderate injury. It may also be used to alert against unsafe practices.

SAFETY RULES

Read, understand, and follow all safety practices in Owner/Operator Manual before use. Failure to follow instructions could result in personal injury and/or damage to unit.

Complete a walk around inspection of unit and work area to understand:

- Work area
- Your unit
- All operational decals.

Inspect unit before each use for: missing or damaged decals and shields. Replace or repair as needed.

Keep children out of work area and under watchful care of a responsible adult.

Check for weak spots on docks, ramps or floors.

Avoid uneven work areas and rough terrain. Stay alert for hidden hazards or traffic.

DO NOT operate near drop-offs, ditches, or embankments. Unit can suddenly turn over if wheels move over the edge of a cliff or ditch, or if an edge caves in.

Read the entire Owner/Operator manual. If the operator or the mechanic cannot read the manual, it is the owner's responsibility to explain it to them. Only the user can prevent, and is responsible for accidents or injuries occurring to themselves, other people or property.

Only trained adults may operate or service unit. Training includes actual operation.

NEVER operate unit after or during the use of medication, drugs or alcohol. Safe operation requires your complete and unimpaired attention at all times

Wear adequate safety gear, protective gloves and footwear. NEVER place your hands or any part of your body or clothing inside or near any moving part while unit is running.

DO NOT touch parts that are hot. Allow parts to cool.

ALWAYS keep hands and feet away from all pinch points.

Read, understand, and follow all instructions in the manual and on the machine before starting. Understand:

- How to operate all controls.
- The functions of all controls.
- How to STOP in an Emergency.
- Braking and turning characteristics.

Keep safety devices or guards in place and functioning properly. NEVER modify or remove safety devices.

Never carry passengers. Use only attachments and accessories designed for your unit.

Know the weight of loads. Do not exceed maximum capacity of unit.

Use caution when backing up. ALWAYS back up slowly. Always look down and behind before and while backing. Check all hardware at regular intervals. Keep all nuts, bolts, and wheel nuts properly tightened.

Disengage unit drive by releasing clutch lever before changing gears.

Never leave a running unit unattended. ALWAYS shut off engine before leaving unit. This product is equipped with an internal combustion

type engine. DO NOT use unit on or near any unimproved, forest-covered or brush covered land, dirt, grease, oil of other flammable material, unless

exhaust system is equipped with a spark arrester meeting applicable local, state or federal laws. A spark arrester, if used, must be maintained in effective working order.

Fumes from engine exhaust can cause injury or death. Ensure proper ventilation. Do not run engine in a confined area.

CONTROLS AND FEATURES

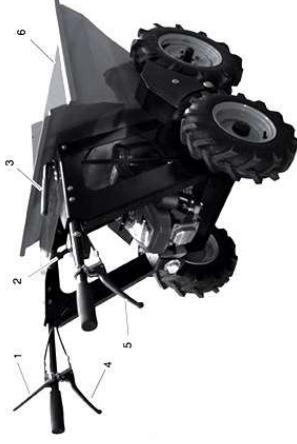

1. Parking Break Lever
2. Throttle Lever (not needed)

3. Gear Selection Lever
4. Clutch Lever
5. Skip Release Lever
6. Skip



7. On/Off Button
8. Standby Button
9. Battery Slots
10. Battery Cover
11. Battery Release Button
12. Battery

OPERATION

CONTROLS AND FEATURES

See *CONTROLS AND FEATURES* on page 5.

Throttle Lever

(Figure 4)

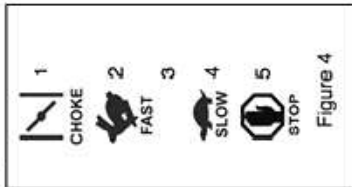

The throttle lever controls the choke position and the engine speed. To choke the engine for startup adjust to:

1. CHOKE (startup)
- To increase or decrease the engine speed, adjust to:
2. FAST
3. Part-Throttle
4. SLOW To stop the engine, adjust to
5. STOP (engine is off)

Parking Brake Lever

(Figure 5)

Engage the parking brake by releasing the lever when not traveling with the unit or while emptying the skip. The parking brake lever must be disengaged (pressed down against handlebar) any time that the unit is in motion.



CAUTION: Avoid damage. Unit has sufficient power to overpower the parking brake. Not releasing parking brake while traveling will lead to overheating and premature wear of the parking brake.

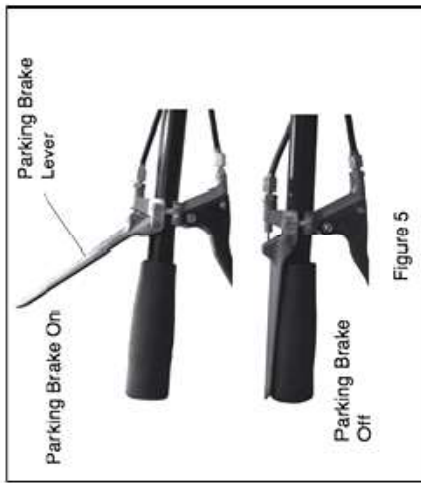

Clutch Lever

(Figure 6)

With a forward or reverse gear selected, gently engage (squeeze) the clutch lever to move the unit forward or backward. Release the clutch lever to stop motion.



Gear Selection Lever

The gear selection lever controls forward and reverse motion of the unit and adjusts the forward travel speed. Select the desired gear based on travel conditions.

Skip Release Lever

(Figure 8)

Squeeze the skip release lever to release the skip lock. Release the skip release lever to engage the skip lock.



Please see EGO Power Unit Manual for Instruction and maintenance information.

EGO™

POWER+ POWER UNIT

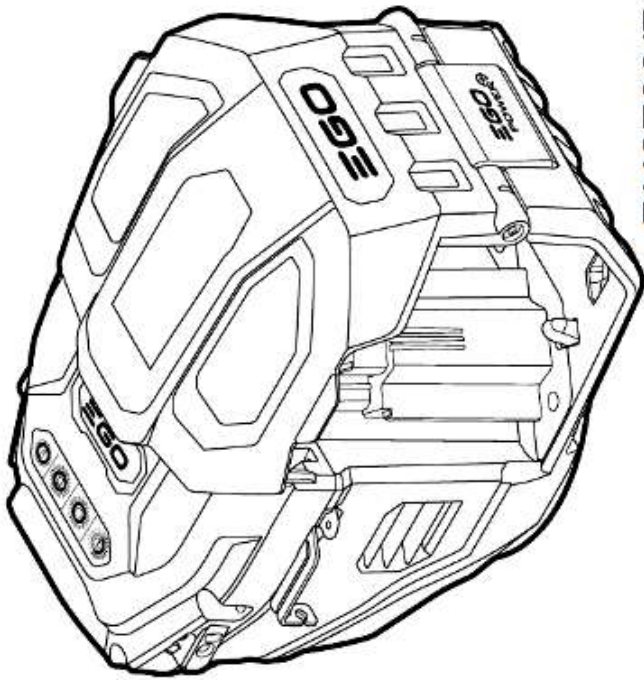

PU2700/PU2700S
UNIVERSAL POWER UNIT

To Empty Skip

1. Stop unit and release parking brake lever.
2. Release the skip lock by squeezing the skip release lever.
3. Jerk both handlebar handles upwards. The skip will pivot forward and dump the load.

To Reset Skip

1. Pull back on the skip.
2. Engage the skip lock by releasing the skip lock lever.
3. Ensure that skip lock has engaged before moving unit.

MAINTENANCE

MAINTENANCE CHECK LIST

Perform routine checks as outlined below. Correct any problems before using unit.

Component	Daily	Weekly
Skip Lock Spring	X	
Drive Belt Tension		X
Parking Brake Adjustment	X	
Control Cable Condition & Adjustment	X	
Air Cleaner		X
Tire Pressures	X	
Attaching Hardware		X

*SAE 10W-30 oil is recommended for general use. Refer to engine manual for engine maintenance procedures.

Tyre Pressure

- Check tyre air pressures regularly. Recommended inflation pressure is 2.8 bar (30 psi) for all tyres.



CAUTION: Avoid injury! Explosive separation of tyre and rim parts is possible when they are serviced incorrectly:

- Do not attempt to mount a tyre without the proper equipment and experience to perform the job.
- Do not inflate the tyres above the recommended pressure.
- Do not weld or heat a wheel and tyre assembly. Heat can cause an increase in air pressure resulting in an explosion. Welding can structurally weaken or deform the wheel.
- Do not stand in front of, or over the tyre assembly when inflating.

SERVICE AND ADJUSTMENTS

LEVER ADJUSTMENTS

(Figure 10)

Primary clutch and skip release cable adjustments are made at the levers. To adjust:

1. Loosen lock nut (item 1).
2. Adjust cable by rotating adjustment nut (item 2). Moving adjustment nut away from the lever will result in earlier engagement.
3. Tighten lock nut.

Left Handlebar



Right Handlebar



1. Lock Nut
2. Adjustment Nut
3. Clutch Lever
4. Skip Release Lever

Figure 10

ADDITIONAL ADJUSTMENTS

(Figure 11)

If clutch, or skip release cable adjustments at the levers are insufficient, additional adjustments can be made to the cables under the unit:

1. Place unit in service position (See Service Position in this section).
2. Loosen lock nuts on the cable.
3. Adjust cable to desire position.
4. Tighten lock nuts.

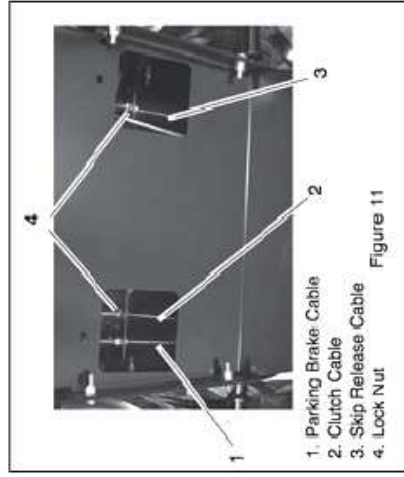

1. Parking Brake Cable
2. Clutch Cable
3. Skip Release Cable
4. Lock Nut

Figure 11

Parking Brake Disc

(Figure 12)

If the cable adjustments do not allow parking brake to fully engage, tighten the lever attachment nut on the transmission.

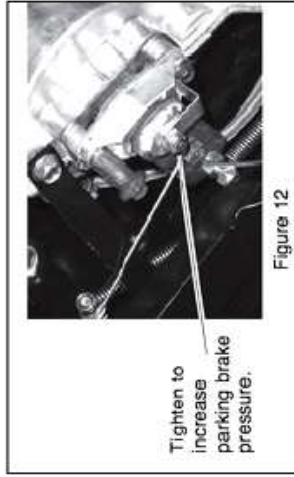

Tighten to increase parking brake pressure.

Figure 12

SERVICE POSITION

(Figure 13)

To access the drive belt and cable attachment points place the unit in the service position by tipping it on its front wheels and front skip edge.

Be sure to move the fuel shut-off valve to the closed position before placing in service position (see Fuel Shut-Off Valve on page 7).



Figure 13

DRIVE BELT REPLACEMENT

(Figure 14)

NOTES

Removal

1. Remove two M8 hex bolts retaining bottom panel at front of unit.
2. Place unit in service position (see SERVICE POSITION above).
3. Remove remaining four M8 hex bolts retaining the bottom panel and remove the panel.
4. Loosen the hex nut retaining the belt guide tube (item 1) enough to allow belt to be removed from transmission pulley (item 2).
5. Remove the belt guide bolt (item 7) from the idler arm (item 4).
6. Remove the belt from the unit.

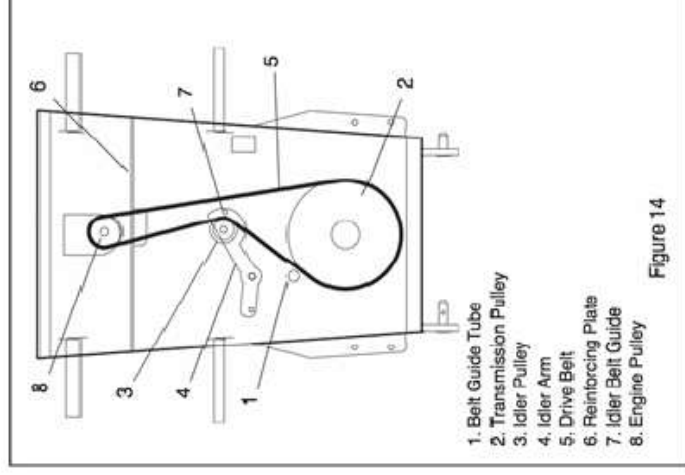

Installation

1. Install replacement belt on transmission pulley (item 2).
2. Tighten belt guide tube (item 1).
3. Route belt to right side of idler pulley (item 3). Outer flat portion of belt will contact pulley.
4. Install idler belt guide bolt (item 7).
5. Route belt through opening in reinforcing plate (item 6) and onto engine pulley (item 8).
6. Adjust clutch as needed. See LEVER ADJUSTMENTS on page 9.
7. Install bottom panel.

PARTS LIST

COWLING, CONTROLS & SKIP

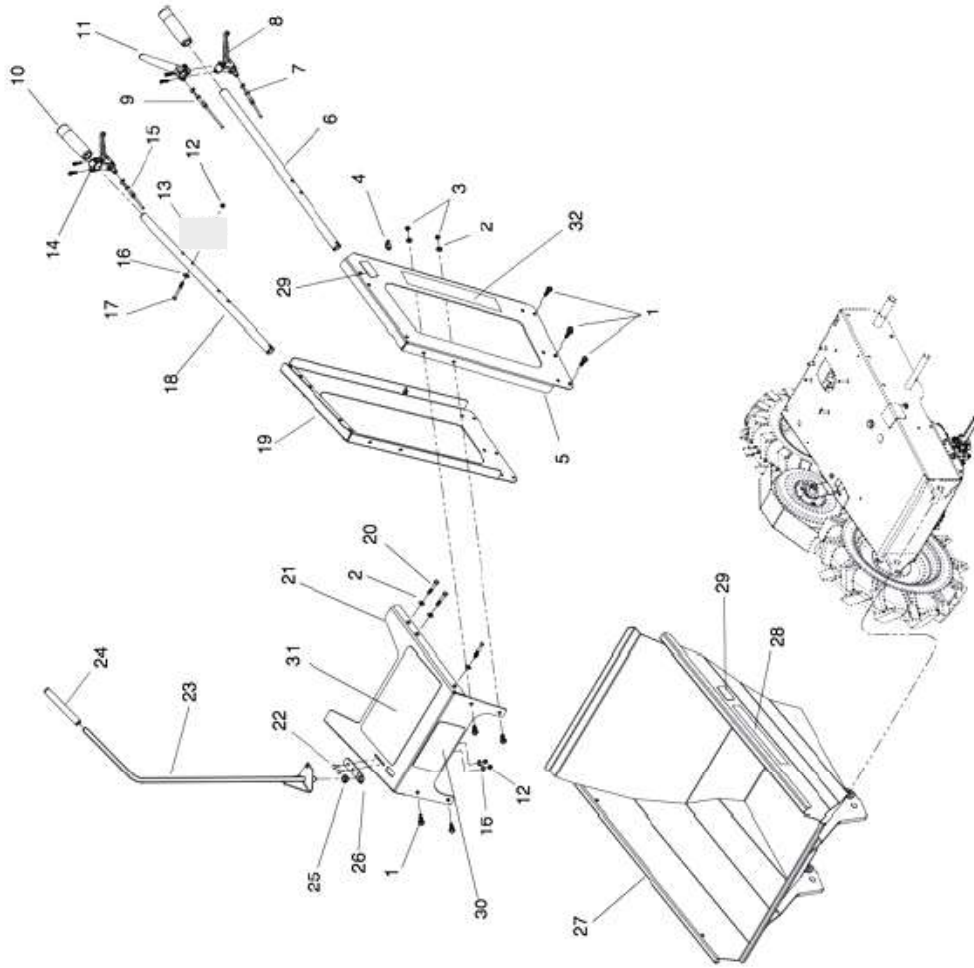

COWLING, CONTROLS & SKIP (CONT'D)

Item	Part No.	Qty.	Description
1		18	Hex head setscrew M8 x 20
2		64	Washer, M8 form A.
3		40	Nut M8 Nyloc type P
4		2	Cable Tie 3.6mm x 140
5	MT 04032	1	Cowling Side Left Hand (Muck-Truck Mk V)
6	MT 03956	1	Cowling Side Left Hand (MAX Mk III)
7	MT 03965	1	Tube, Handle – Left Hand (MAX Mk III)
8	MT 04058	1	Tube, Handle – Left Hand (Muck-Truck Mk V)
9	MT 03943	1	Cable, Clutch Control
10	DP0502015	1	Lever, Clutch
11	MT 03943	1	Cable, Brake
12	DP03	2	Grip, Handle 22 mm x 135 mm
13	DP0502016	1	Lever, Brake Control - Red
14	DP0502014	1	Lever, Skip Catch, With Clamp and Screws
15	MT 03943	1	Cable, Skip Release
16			
17			
18	MT 03966	1	Tube, Handle – Right Hand (MAX Mk III)
19	MT 04059	1	Tube, Handle – Right Hand (Muck-Truck Mk V)
20	MT 04031	1	Cowling Side Right Hand (Muck-Truck Mk V)
21	MT 03958	1	Cowling Side Right Hand (MAX Mk III)
22		4	Bolt, Hex M8 x 50 long
23	MT 04034	1	Cowling Cover (Muck-Truck Mk V)
24	MT 03959	1	Cowling Cover (MAX Mk III)
25		2	Coach Bolt M6 x 20 long
26	MT 03961	1	Gear Change Lever (MAX Mk III)
27	MT 04054	1	Gear Change Lever (Muck-Truck Mk V)
28	DT107	1	Grip, Gear Lever
29		1	Bearing, Flange 008 1603000 02
30	MT 03963	1	Gear Lever Guide- Plate
31	MT 03034	1	Skip (Muck-Truck Mk V)
32	MT 03975	1	Skip (MAX Mk III)
33		2	Decal, Skip – Load Capacity (Muck-Truck Mk V)
34	MT 04015	2	Decal, Skip – MAX
35	MT 04016	4	Decal, Maximum Skip Load Capacity (MAX Mk III)
36		2	Decal, Maximum Skip Load Capacity (Muck-Truck Mk V)
37	MT 04017	1	Decal, Maintenance
38	MT 03988	1	Decal, Operation
39	MT 04018	2	Decal, Muck-Truck

TRANSMISSION AND BELT DRIVE

TRANSMISSION AND BELT DRIVE (CONT'D)

Item	Part No.	Qty.	Description
1		1	Bolt, Hex head M12 x 75 long
2		18	Hex head setscrew M8 x 20 long
3		40	Nut M8 Nyloc type P
4		64	Washer, M8 form A
5		8	Bolt, M8 x 65 long
6	MT 03962	1	Gear Change Linkage (Includes items 37, 38 and 39)
7		1	Bolt, M10 x 45 long
8		2	Washer, M10 form A
9	DP 05043	1	Plate, Clutch Reinforcing
10		6	Washer, M12 form A
11		1	Coach Bolt M12 x 60 long
12	MT 03021	1	Tube, Belt Guide
13		3	Nut, M8 Full
14		5	Hex head setscrew, M8 x 35 long
15		4	Nut M12 Nyloc type P
16		1	Nut M10 Nyloc type P
17	MT 03951	1	Clutch Lever
18	MT 03953	1	Clutch Pulley
19		1	Bolt M8 x 60 long
20	MT 03942	3	Hex head setscrew, 5/16" UNC x 3/4" long *
21		1	Pulley, Transmission
22		1	Key, Woodruff 3/8" x 3/16"
23	DP18	3	Spring
24	MT 03945	1	Brake Arm Link
25	DP21	1	Transmission, Peerless
26		2	Setscrew, Hex head/flanged Self-Tapping M8 x 20 long
27	MT03020	2	Torque Stay
28		2	Nut M8 Nyloc type P
29	MT 03973	1	Plate, Shifter
30		1	Washer, M6 form C
31		1	Washer M6 Spring Lock
32		1	Hex head setscrew 3/4" UNF x 3/4" long
33	DP0502018	1	Belt, 5 1"
34		1	Key, Woodruff 3/32" x 5/8"
35	MT 03001	1	Pulley, Engine
36	MT 03977	1	Skip Release Catch
37		2	Ball Joint M8. Part of item 6
38		2	Nut, M8 full. Part of item 6
39		1	Rod, Gear Linkage. Part of item 6
40	MT 03944	1	Clutch Arm Link
41	MT 03942	1	Spacer, Clutch Pivot

* Torque to 15 - 20 lbf-ft.

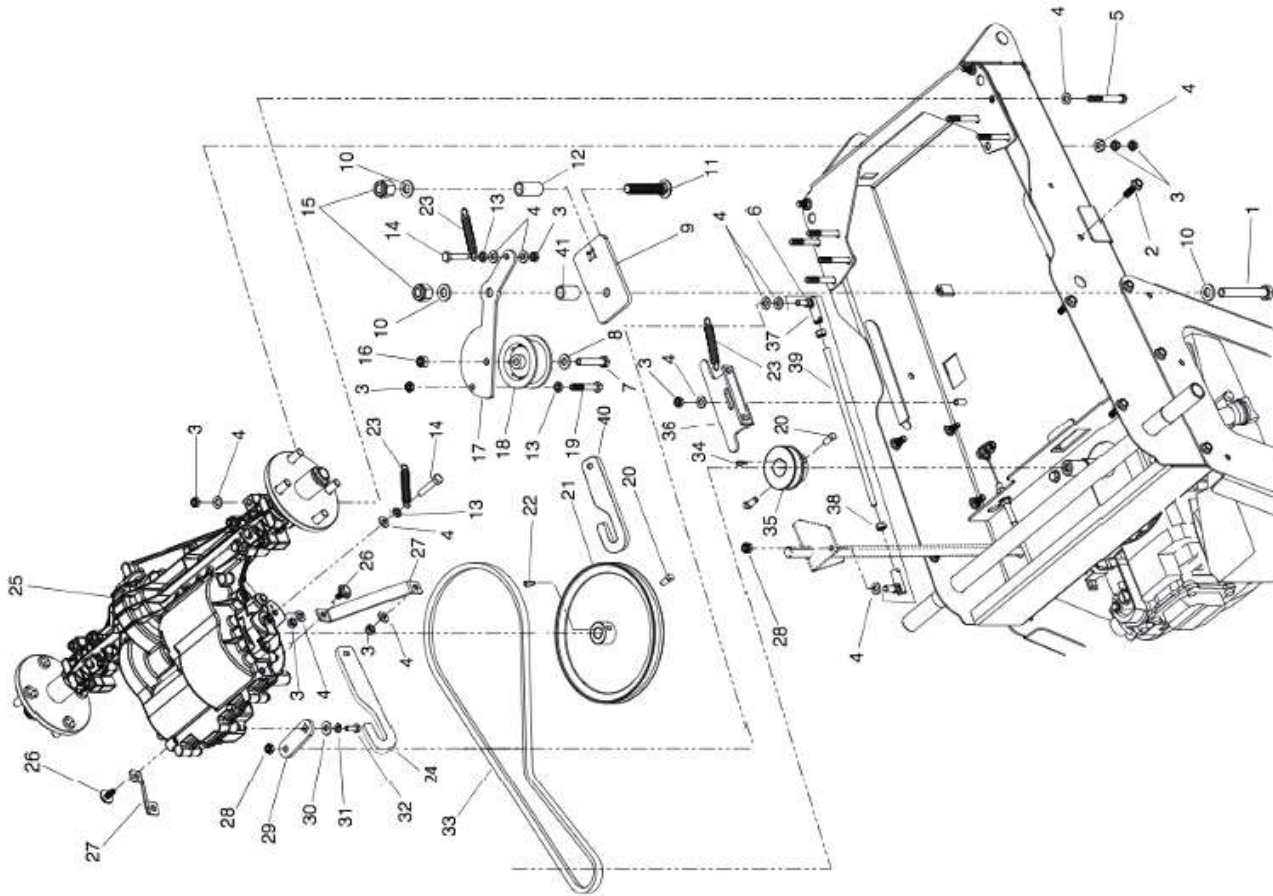

MAINFRAME & DRIVETRAIN

MAINFRAME & DRIVETRAIN (CONT'D)

Item	Part No.	Qty.	Description
1	MT 04028	1	Mainframe (Muck-Truck Mk V)
2	MT 03984	1	Mainframe (MAX Mk III)
3		4	Hex Head setscrew 5/16" UNF x 1" long
4	DP 05041	2	Key, Square 3/16" x 55mm long
5	MT 03948	2	Front Hub
6		1	Bottom Plate
7		64	Washer, M8 form A
8		40	Nut M8 Nyloc type P
9	DP80	2	E-Ring, 7.50" x .050" N1500 Code 0075
10		2	Cap. Vinyl 1.25 x 1.625
11		5	Bolt, M8 x 40 long
12	DP83	16	Wheel nut M10 x 1.25 Pitch
13		2	Starcap 19mm
14	MT 03019	2	Coach Bolt M12 x 130 long
15		2	Power Drive Bracket
16	DP45	4	Nut M12 Nyloc type P
17		2	Wheel Assembly, Power Drive (4")
18		6	Washer, M12 form A
19		2	Chrome plated wheel cap
20	DP30 LH	2	Circlip EXT0250
21		1	Wheel Assembly, Left Hand Rear (Muck-Truck Mk V) (8")
22		18	Hex head setscrew M8 x 20 long
23	DP31	1	EGO Power Unit
24	DP24 RH	1	Pin, Lynch
25	DP24 RH	1	Wheel Assembly, Right Hand (Muck-Truck Mk V) (10")
26	DP30 RH	2	Wheel Assembly, Right Hand (MAX Mk III) (10")
27	DP24 LH	1	Wheel Assembly, Right Hand Rear (Muck-Truck Mk V) (8")
28	DP24 LH	1	Wheel Assembly, Left Hand (Muck-Truck Mk V) (10")
29	MT 04018	2	Wheel Assembly, Left Hand (MAX Mk III) (10")
30		2	Decal, Muck Truck Logo
31		2	Chrome plated wheel cap
32	MT 03980	2	Circlip EXT0250
		2	Hub Assembly, Rear Wheel (MAX Mk III)
		2	Bearing, Ball 25 mm x 52 mm 6205 2RS
		4	Wheel stud M10 x 1.25 pitch x 35 long

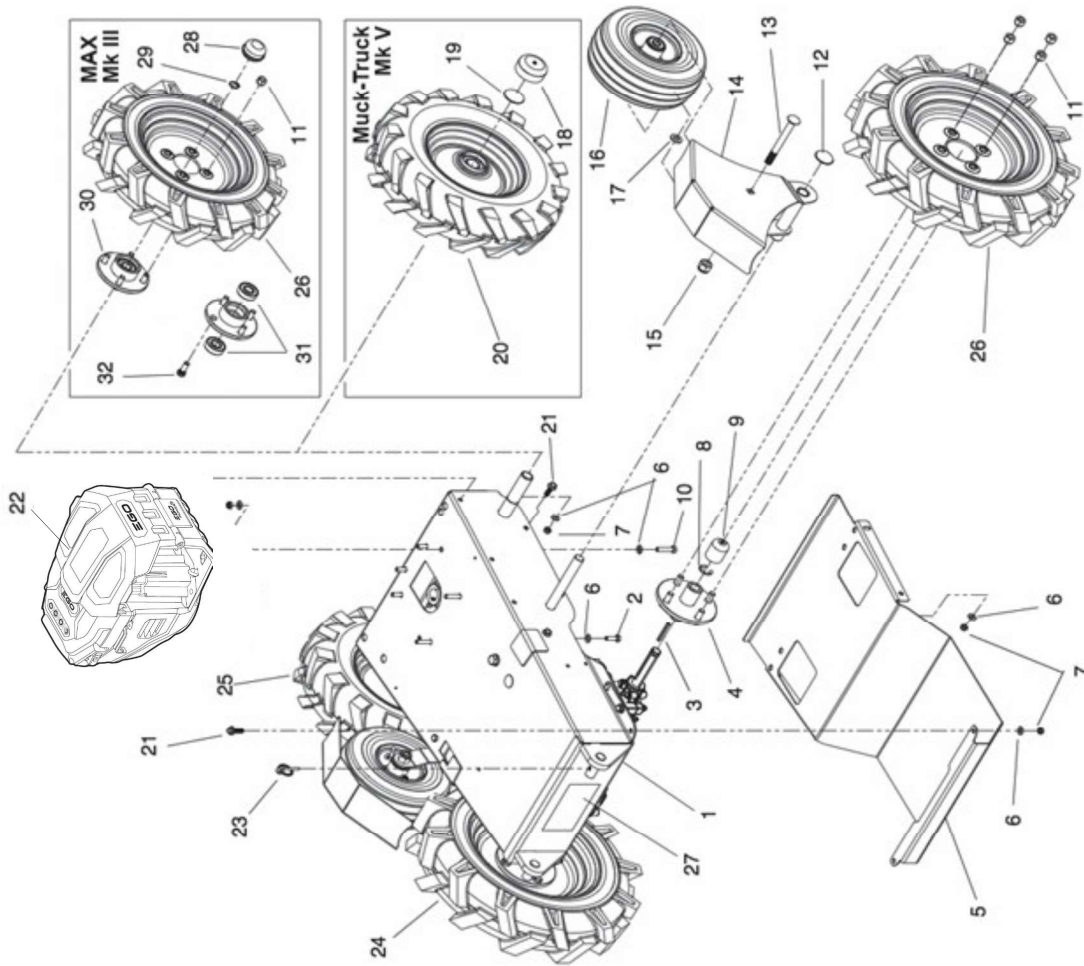

Serial Number:

--

Warranty is 12 calendar months from date of sale for Consumers and 90 days for units used in the Commercial Sector. Under the following conditions:

- Routine maintenance completed in accordance with Owners Manual.
- Returned defective parts are approved by Muck Truck UK Ltd.
- Machine is not abused or operated with known faults or lack of maintenance.
- Repairs are in accordance with Muck Truck UK Ltd.

AT AN AGREED JOB RATE

Only defective parts are covered, and not wearable components that require replacement because of normal wear; for example puncture, chipped paint, dented skip etc. Muck Truck UK Ltd will not be held liable for any consequential losses.

PERSONAL CUSTOMER GUARANTEE STATEMENT

If there is any component, or components, manufactured by Muck Truck UK Ltd, that are found to be defective within 12 months from the date of purchase (or 90 days in the case of a machine used for hire/commercial purposes), Muck Truck UK Ltd, will replace the faulty component(s) free of charge, provided they are notified immediately upon date of failure.

THE FOLLOWING ARE NOT COVERED BY THIS GUARANTEE

1. Engines - Engines are guaranteed by their respective manufacturers.
2. A machine which has been subject to operation in excess of recommended capacities, misuse, negligence or accident; or has been altered or modified in a manner which has not been authorized by Muck Truck UK Ltd.
3. Wear parts - belts, cables etc.
4. Transportation Charge - to and from the warranty repair site.

Muck Truck UK Ltd operates a policy of continual development and reserves the right to alter product specifications without giving prior notice



POWER+ POWER UNIT



PU2700/PU2700S

UNIVERSAL POWER UNIT

Clear copy is on a Separate Booklet

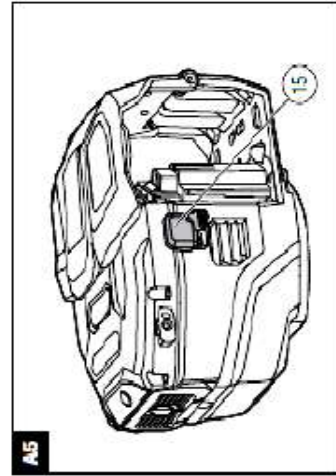
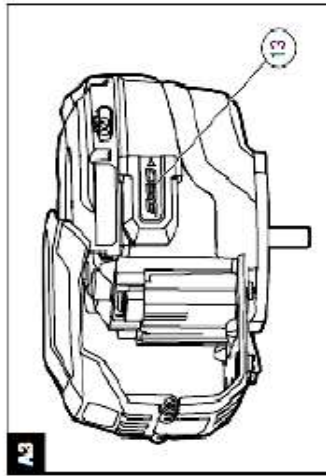
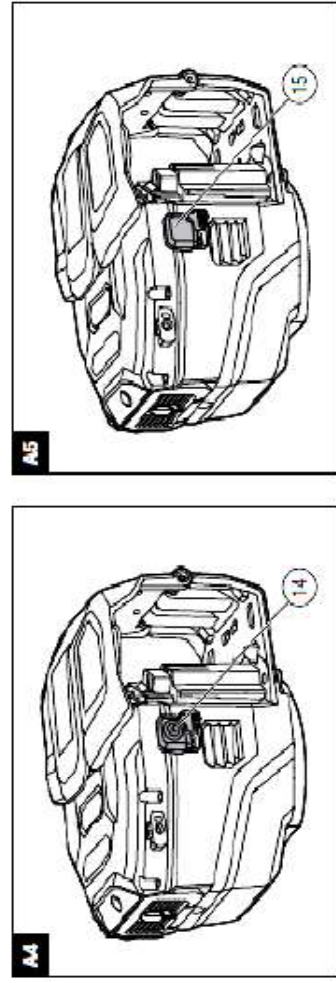
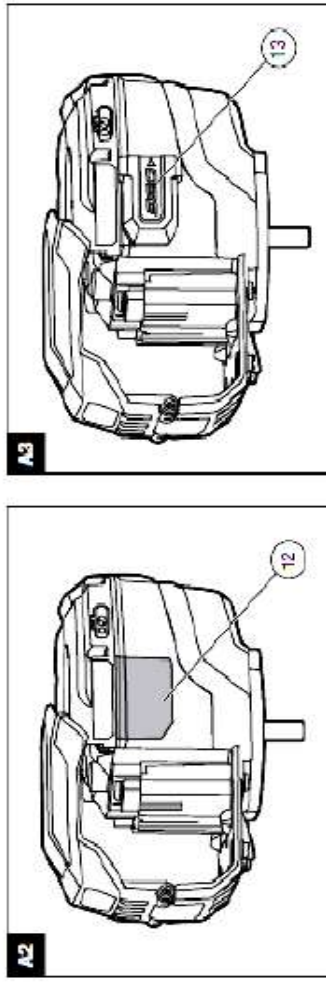
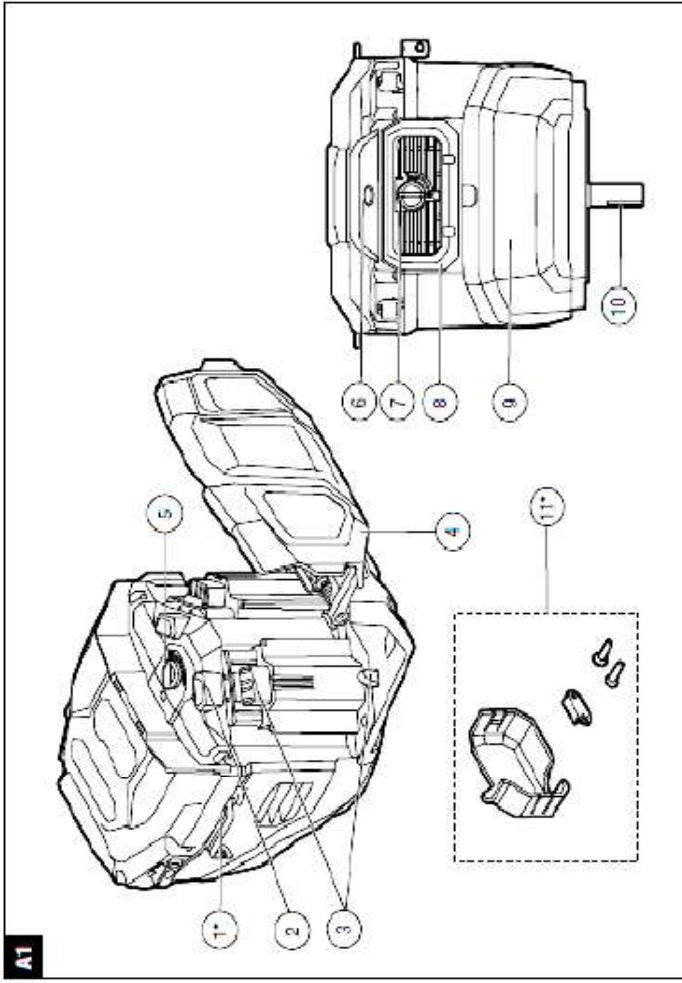

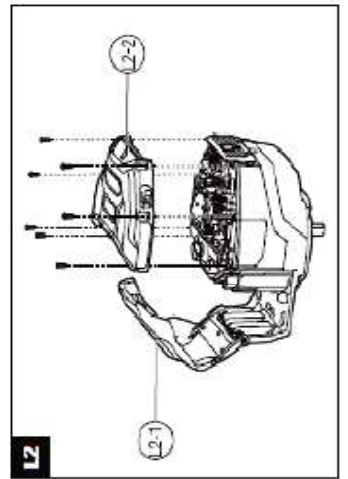
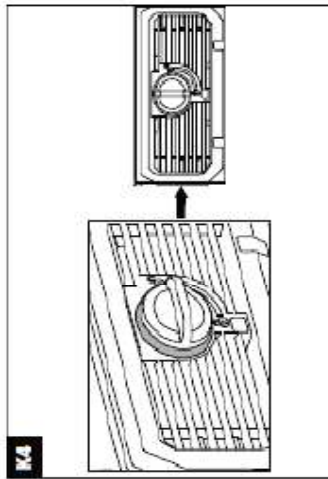
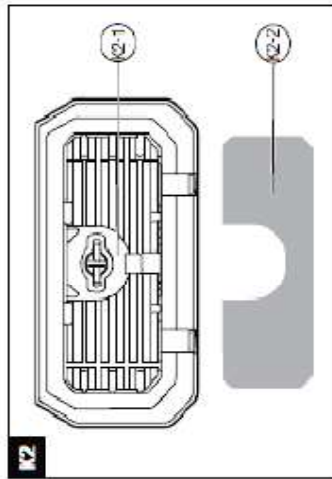
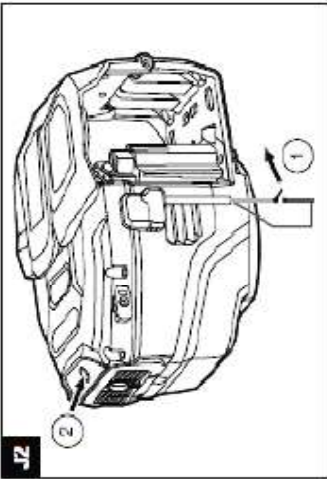
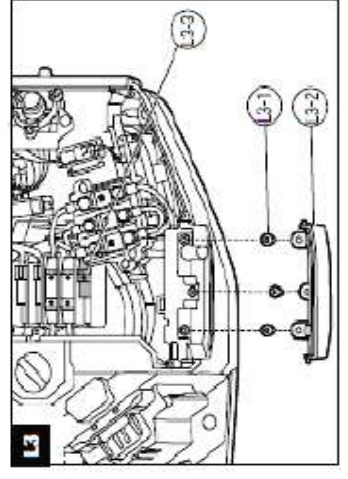
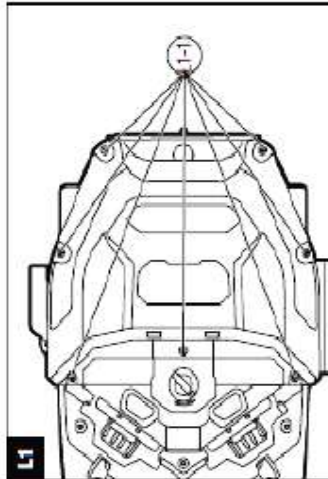
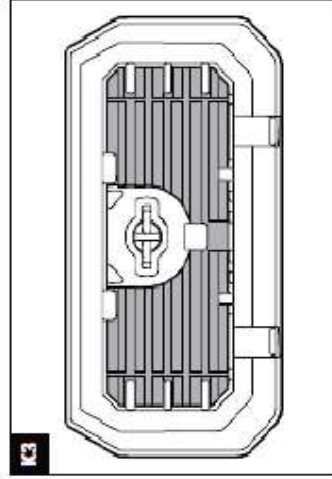
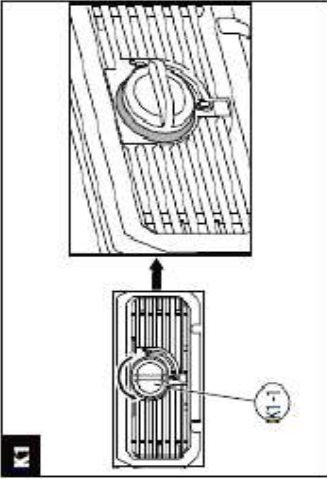
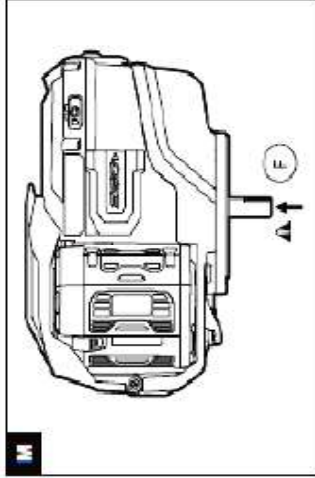
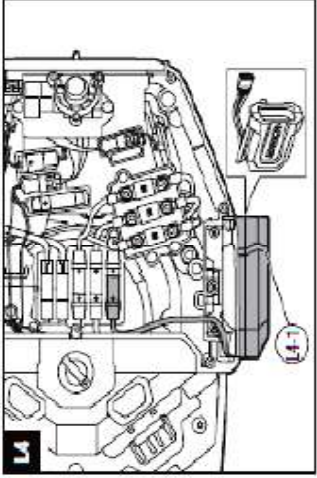
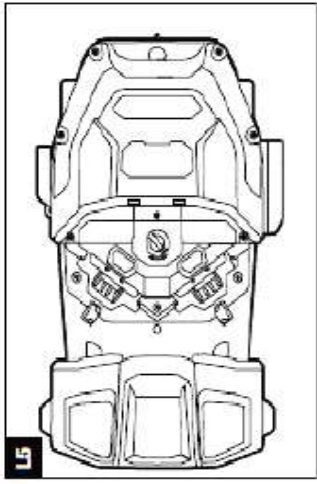



SAFETY INSTRUCTIONS

⚠ WARNING: Read all safety warnings, instructions, illustrations and specifications provided with this tool. Failure to follow all instructions listed below may result in electric shock, fire and/or serious injury.

SAVE ALL WARNINGS AND INSTRUCTIONS FOR FUTURE REFERENCE.

- Keep work area clean and well lit. Cluttered or dark areas invite accidents.
- Do not operate the power unit in explosive atmospheres, such as in the presence of flammable liquids, gases or dust.
- Distractions can cause you to lose control.
- Match the socket (if applicable) with the proper plug. Never modify the socket and the plug in any way. Unmodified plugs and matching sockets will reduce risk of electric shock.
- Don't expose the power unit to heavy rain. Water entering will increase the risk of electronic parts failure.
- Stay alert, watch what you are doing and use common sense when operating the power unit. Do not use the power unit while you are tired or under the influence of drugs, alcohol or medication. A moment of inattention while operating the power unit may result in serious personal injury.
- Use personal protective equipment. Protective equipment such as dust mask, non-skid safety shoes, hard hat or hearing protection used for appropriate conditions will reduce personal injuries.
- Dress properly. Do not wear loose clothing or jewelry. Keep your hair and clothing away from moving parts. Loose clothes, jewelry or long hair can be caught in moving parts.
- Do not let familiarity gained from frequent use of tools allow you to become complacent and ignore tool safety principles. A careless action can cause severe injury within a fraction of a second.
- Have your power unit serviced by a qualified repair person using only identical replacement parts. This will ensure that the safety of the power unit is maintained.
- Always take extra caution when starting the power unit without assembling it the tool completely.

- Do not use a battery pack or tool that is damaged or modified. Damaged or modified batteries may exhibit unpredictable behavior resulting in fire, explosion or risk of injury.
- Do not expose a battery pack or tool to fire or excessive temperature. Exposure to fire or temperature above 130°C may cause explosion.
- Follow all charging instructions and do not charge the battery pack or tool outside the temperature range specified in the instructions. Charging improperly or at temperatures outside the specified range may damage the battery and increase the risk of fire.
- Never service damaged battery packs. Service of battery packs should only be performed by the manufacturer or authorized service providers.
- Refer to the battery pack instruction manual for precautions about battery packs.

Clutch control	PU2700/PU2700S: Bowden cable PU2700B: Start/Stop button PU2700E: A switch or other equivalent (not provided)
Electronic brake	Yes
PTO shaft	Vertical
PTO shaft rotation (from PTO shaft side)	Counterclockwise
PTO shaft dimensions	Refer to Fig. A6
Recommended operating temperature	-15°C - 40°C
Recommended storage temperature	0°C - 50°C

DESCRIPTION

KNOW YOUR POWER UNIT (Fig. A1 – A3)

- Bowden cable metal bracket* (only for PU2700/PU2700S)
- Battery release button
- Ejection mechanism
- Battery compartment cover
- Eco/Turbo switch
- Power on/off button applicable for PU2700/PU2700S/PU2700E
- Lock knob
- Air cleaner
- Base
- PTO shaft
- Accessories for cable connection* (only for PU2700B/PU2700E)
- Shield cover
- BAX1500 battery socket
- Start/Stop button & Safety circuit interface* (only for PU2700B)
- Electronic switch interface* (only for PU2700E)

PACKING LIST

Model	Parts
PU2700	Fig. A2
PU2700S	Fig. A3
PU2700B	Fig. A1-11 & Fig. A4
PU2700E	Fig. A1-11 & Fig. A5

ASSEMBLY

- PU2700/PU2700S

Connect the Bowden cable to the metal bracket (Fig. B)

B-1	Bowden cable (not provided)	B-2	Metal bracket
-----	-----------------------------	-----	---------------

- PU2700B/PU2700E

- Connect the wire connector and a switch or other equivalent into the circuit by a two-core cable (Fig. C1).

C1-1	Wire connector	C1-2	Two-core cable (not provided)
C1-3	A switch or other equivalent (not provided)		

- Tighten the clamp plate with screws and then close the protective cover (Fig. C2).

C2-1	Clamp plate	C2-2	Screws
C2-3	Protective cover		

OPERATION

PRE-OPERATION CHECK

- Air cleaner (Fig. D)

Check the air cleaner elements to be sure they are clean and in good condition.

Clean or replace the elements if necessary following the instructions in section "AIR CLEANER SERVICE".

⚠ CAUTION: Never run the power unit without the air cleaner. Rapid wear will result.

Speed adjustment (Fig. E)

Turn the Eco/Turbo switch to switch the speed between "ECO" and "TURBO".

NOTICE: The speed adjustment function will activate only when the power unit is stopped.

BATTERY PACK ATTACHMENT/DETACHMENT

Use only with the recommended EGO's battery packs and chargers (Fig. A7). For optimum performance, it is recommended to attach: 2 x 12Ah, 2 x 10Ah or at least 2 x 7.5Ah batteries.

NOTICE: Do not use BAX1500 backpack battery alone, otherwise the performance of power unit is limited.

SPECIFICATION

Voltage	56 V ---
Length x Width x Height	405 mm x 310 mm x 276 mm
Weight (without battery pack)	11.8 kg
IP	IPX5
Battery port	PU2700/PU2700B/PU2700E: Dual Ports PU2700S: Three Ports
Speed control	Eco/Turbo modes
Malfunction LED indicator	Yes
Cooling system	Air cooled
Air cleaner	Easy replaceable sponge mesh
Net power output	3.47 kW@3450 RPM
Max. net torque	9.2 N.m@3450 RPM

Clutch control	PUZ700/PUZ700S: Bowden cable PUZ700B: Start/Stop button PUZ700E: A switch or other equivalent (not provided)
Electronic brake	Yes
PTO shaft	Vertical
PTO shaft rotation (from PTO shaft side)	Counterclockwise
PTO shaft dimensions	Refer to Fig. A6
Recommended operating temperature	-15°C - 40°C
Recommended storage temperature	0°C - 50°C

DESCRIPTION

KNOW YOUR POWER UNIT (Fig. A1 - A3)

- Bowden cable metal bracket* (only for PUZ700/PUZ700S)
- Battery release button
- Ejection mechanism
- Battery compartment cover
- Eco/Turbo switch
- Power on/off button applicable for PUZ700/PUZ700S/PUZ700E
- Lock knob
- Air cleaner
- Base
- PTO shaft
- Accessories for cable connection* (only for PUZ700B/PUZ700E)
- Shield cover
- BAX1500 battery socket
- Start/Stop button & Safety circuit interface* (only for PUZ700B)
- Electronic switch interface* (only for PUZ700E)

PACKING LIST

Model	Parts
PUZ700	Fig. A2
PUZ700S	Fig. A3
PUZ700B	Fig. A1-11 & Fig. A4
PUZ700E	Fig. A1-11 & Fig. A5

ASSEMBLY

■ PUZ700/PUZ700S

Connect the Bowden cable to the metal bracket (Fig. B)

B-1	Bowden cable (not provided)	B-2	Metal bracket
-----	-----------------------------	-----	---------------

■ PUZ700B/PUZ700E

- Connect the wire connector and a switch or other equivalent into the circuit by a two-core cable (Fig. C1).

C1-1	Wire connector	C1-2	Two-core cable (not provided)
C1-3	A switch or other equivalent (not provided)		

- Tighten the clamp plate with screws and then close the protective cover (Fig. C2).

C2-1	Clamp plate	C2-2	Screws
C2-3	Protective cover		

OPERATION

PRE-OPERATION CHECK

■ Air cleaner (Fig. D)

Check the air cleaner elements to be sure they are clean and in good condition.

Clean or replace the elements if necessary following the instructions in section "AIR CLEANER SERVICE".

CAUTION: Never run the power unit without the air cleaner. Rapid wear will result.

Speed adjustment (Fig. E)

Turn the Eco/Turbo switch to switch the speed between "ECO" and "TURBO".

NOTICE: The speed adjustment function will activate only when the power unit is stopped.

BATTERY PACK ATTACHMENT/DETACHMENT

Use only with the recommended EGO's battery packs and chargers (Fig. A7). For optimum performance, it is recommended to attach: 2 x 12Ah, 2 x 10Ah or at least 2 x 7.5Ah batteries.

NOTICE: Do not use BAX1500 backpack battery alone, otherwise the performance of power unit is limited.

Fully charge before first use.

- Open the battery compartment cover (Fig. F1).
- To attach the battery pack, align the battery ribs with the guiding slots of the power unit and press the battery pack down until you hear a "click" (Fig. F2).
To detach the battery pack, press the battery-release button and lift the battery pack out of the battery compartment (Fig. F3).
- Close the battery compartment cover and the cover would be closed tightly by the magnetic force (Fig. F1).

F1-1 Magnets

STARTING & STOPPING THE POWER UNIT

■ PUZ700/PUZ700S

To start the power unit, briefly press the power on/off button and the green color lights, then the machine can be started by pulling Bowden cable as your designed (Fig. G1).

NOTE: When the power on/off button is activated, the standby time is 120s. Pull the Bowden cable within this time. If not, the power unit will deactivate automatically.

To stop the power unit, just release the Bowden cable to the original position (Fig. G2).

NOTICE: To prevent unexpected startup, it is recommended to turn off the power unit completely.

During the standby time, press and hold the power on/off button until the light goes out to turn off the power unit.

■ PUZ700B

To start the power unit, press the start/stop button when the safety circuit is closed, otherwise please close the safety circuit first (Fig. H1).

To stop the power unit, press the start/stop button again (Fig. H2).

■ PUZ700E





To start the power unit, briefly press the power on/off button and the green color lights, and then turn on the connected electronic switch (not provided) (Fig. J1).

NOTE: When the power on/off button is activated, the standby time is 120s. Press the switch within this time. If not, the power unit will deactivate automatically.

To stop the power unit, turn off the connected electronic switch (not provided) (Fig. J2).

NOTICE: To prevent unexpected startup, it is recommended to turn off the power unit completely. During the standby time, press and hold the power on/off button until the light goes out to turn off the power unit.

POWER ON/OFF DISPLAY

DISPLAY	MEANING	ACTION
Solid green	The power unit is working properly.	None required.
Solid orange 	Power unit is over temperature	<ul style="list-style-type: none"> Check and clean the air cleaner. Reduce the load and avoid using the power unit in high temperature environment.
Flash red 	Low voltage	Recharge the battery pack(s).
Flash orange 	Over load	Reduce the working load.
Flash red and flash green alternately 	Communication failure	Contact EGO service center for repair.

MAINTENANCE

WARNING: To prevent personal injury, remove the battery packs before servicing, cleaning the unit.

WARNING: When servicing, use only identical replacement parts. Use of any other parts may create a hazard or cause product damage. To ensure safety and reliability, all repairs should be performed by a qualified service technician.

CLEANING THE POWER UNIT

- Clean the power unit using a damp cloth with a mild detergent. Never let any liquid get inside the power unit; never immerse any part of the power unit into a liquid.

- Do not use any strong detergents on the plastic housing. They can be damaged by certain aromatic oils, such as pine and lemon, and by solvents such as kerosene. Moisture can also cause a shock hazard. Wipe off any moisture with a soft, dry cloth.

AIR CLEANER SERVICE

To remove

- Counter-clockwise rotate the lock knob according to the icon illustration on it and take out the air cleaner directly. (Fig. K1).

K1-1 Lock knob

- It is recommended to use air gun blowing clean the sponge mesh filter per need or directly replace a new one if necessary. (Fig. K2).

K2-1 Air cleaner cover

K2-2 Sponge mesh

To install

- Place the sponge mesh into the air cleaner cover. Make sure all sides are laid flat without humps (Fig. K3).
- Place the air cleaner onto the power unit properly.
- Press and clock-wise rotate the lock knob to lock air cleaner in place (Fig. K4).

ASSEMBLING BAX1500 ONTO POWER UNIT

- Loosen and remove the seven screws securing the top cover, then open the battery compartment cover to remove the top cover (Fig. L1 & L2).

L1-1 Screws securing the top cover

L2-1 Battery compartment cover

L2-2 Top cover

- Loosen and remove the three screws securing the shield cover, then remove the shield cover (Fig. L3).

L3-1 Screws securing the Shield cover

L3-2 Shield cover

- Remove the black heat-shrink tube covered on the connector (Fig. L3)

L3-3 Connector

TROUBLESHOOTING

PROBLEM	CAUSE	SOLUTION
The power unit fails to start.	The power on/off button (for PU2700/PU2700S/PU2700E) is not activated.	Press the power on/off button till green color lights.
	The battery pack(s) is not engaged in place in the battery compartment.	Attach the battery pack(s) in the battery compartment, and press it until you hear a "click".
	The Bowden cable (for PU2700/PU2700S) is not pulled enough to trigger the switch.	The travel distance of the Bowden cable should meet the designed requirement of 20 mm.
	The two-core cable (for PU2700B/PU2700E) is not connected properly.	Check and connect the two-core cable properly following the section "ASSEMBLY".
	Other unidentified causes.	Contact a qualified service technician for repair.
The power unit stops working.	The battery pack(s) is depleted.	Charge the battery pack(s).
	The power unit is over loaded.	Reduce the working load.
	The battery pack(s) is over temperature.	Reduce the working load or replace with the larger capacity battery pack(s).
	The power unit is over temperature.	Avoid using the battery pack(s) in high temperature environment.
	Other unidentified causes.	Check and clean the air cleaner. Reduce the load and avoid using the power unit in high temperature environment. Contact a qualified service technician for repair.
The speed makes no changes when switching the Eco/Turbo speed.	If the surrounding is too noisy, it is difficult to recognize changes.	Stop the machine, switch the speed again. Measure the speed difference to further check if necessary.
	Incorrect operation steps.	Restart the power unit following the section "STARTING & STOPPING THE POWER UNIT". If still not work, contact EGO service center for repair.
	The power unit features an automatic adjustment function for overload protection.	Reduce load according to actual situation, and then the power unit will returns to full speed state.

WARRANTY

EGO WARRANTY POLICY

Please visit the website egopowerplus.com for full terms and conditions of the EGO Warranty policy.

- Mount the BAX1500 battery socket onto the power unit and connect the socket cable with the connector of the power unit. Place the cables into corresponding slots, and then fix the BAX1500 battery socket by tightening the three screws. The recommended tightening torque is 1.5-1.8 Nm. (Fig. L4)

L4-1 BAX1500 battery socket (optional)

- Reassemble the top cover onto the power unit by tightening the seven screws. The recommended tightening torque is 1.5-1.8 Nm. (Fig. L5)

TRANSPORTING/STORAGE

TRANSPORTING THE POWER UNIT

CAUTION: In case of damaging the power unit, please never let the PTO shaft be impacted or let force push in the PTO shaft (Fig. M).

STORING THE POWER UNIT

- Remove the battery packs from the power unit.
- Clean the power unit thoroughly before storing.
- Store the power unit in a dry, well-ventilated area, out of the reach of the children. Do not store the power unit on or adjacent to fertilizers, gasoline, or other chemicals.

PROTECTING THE ENVIRONMENT

Do not dispose of electrical equipment, used battery and charger into household waste! Take this product to an authorized recycler and make it available for separate collection. Electric tools must be returned to an environmentally compatible recycling facility.

